

# OK5003

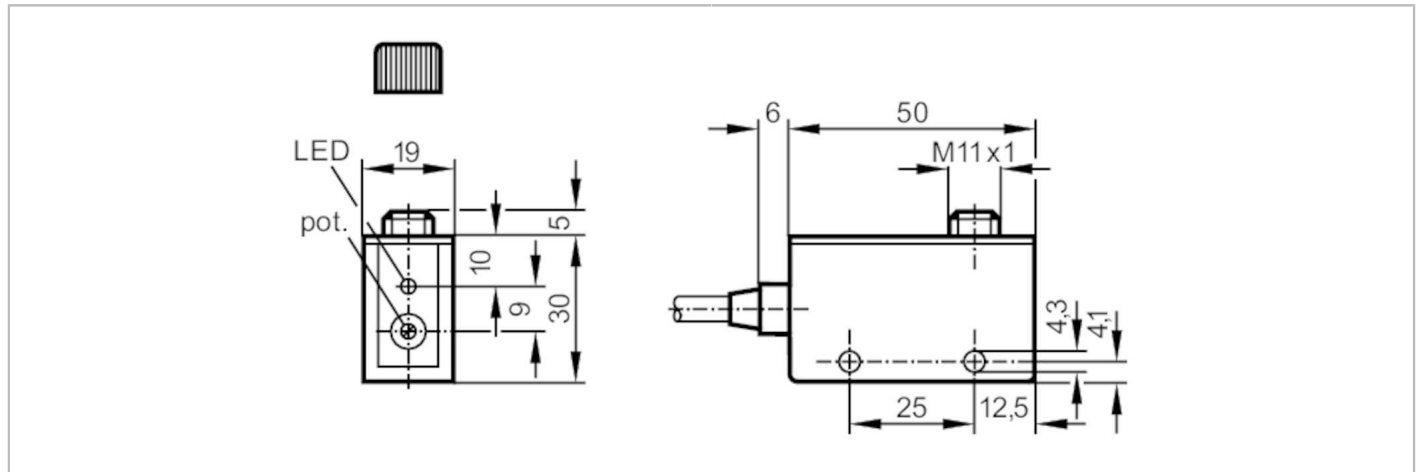

## Fiber-optic amplifier

OKF-FPKG/6M



Product characteristics		
Type of light		red light
Housing		rectangular
Electrical data		
Operating voltage	[V]	10...36 DC
Current consumption	[mA]	30; ((24 V))
Protection class		III
Reverse polarity protection		yes
Type of light		red light
Wave length	[nm]	660
Outputs		
Electrical design		PNP
Output function		light-on/dark-on mode; (programmable)
Max. voltage drop switching output DC	[V]	2.5
Permanent current rating of switching output DC	[mA]	250
Switching frequency DC	[Hz]	120
Short-circuit protection		yes
Type of short-circuit protection		yes (non-latching)
Overload protection		yes
Monitoring range		
Range	[m]	0...0.12; (Through-beam sensor)
Range	[mm]	0...40; (Diffuse reflection sensor)
Range adjustable		yes
Operating conditions		
Ambient temperature	[°C]	-25...60
Protection		IP 65

# OK5003



## Fiber-optic amplifier

OKF-FPKG/6M

### Tests / approvals

EMC	EN 60947-5-2	
	EN 55011	class B
MTTF	[years]	529

### Mechanical data

Weight	[g]	290
Housing		rectangular
Dimensions	[mm]	50 x 19 x 35
Material		PPO modified
Lens alignment		Side sensing

### Displays / operating elements

Display	Switching status	1 x LED, yellow
---------	------------------	-----------------

### Accessories

Items supplied	screwdrivers
	screws: 2 x M4 x 25
	washers: 2
	spring washers: 2
	Nuts: 2

### Remarks

Remarks	light-on mode corresponds to the NC output function for through-beam fibers corresponds to the NO output function for diffuse-reflection fibers
	dark-on mode corresponds to the NO output function for through-beam fibers corresponds to the NC output function for diffuse-reflection fiber optics
Pack quantity	1 pcs.

### Electrical connection

Cable: 6 m, PVC; 4 x 0.34 mm<sup>2</sup>

### Connection



Core colors :  
 BN = brown  
 BU = blue  
 BK = black  
 WH = white